

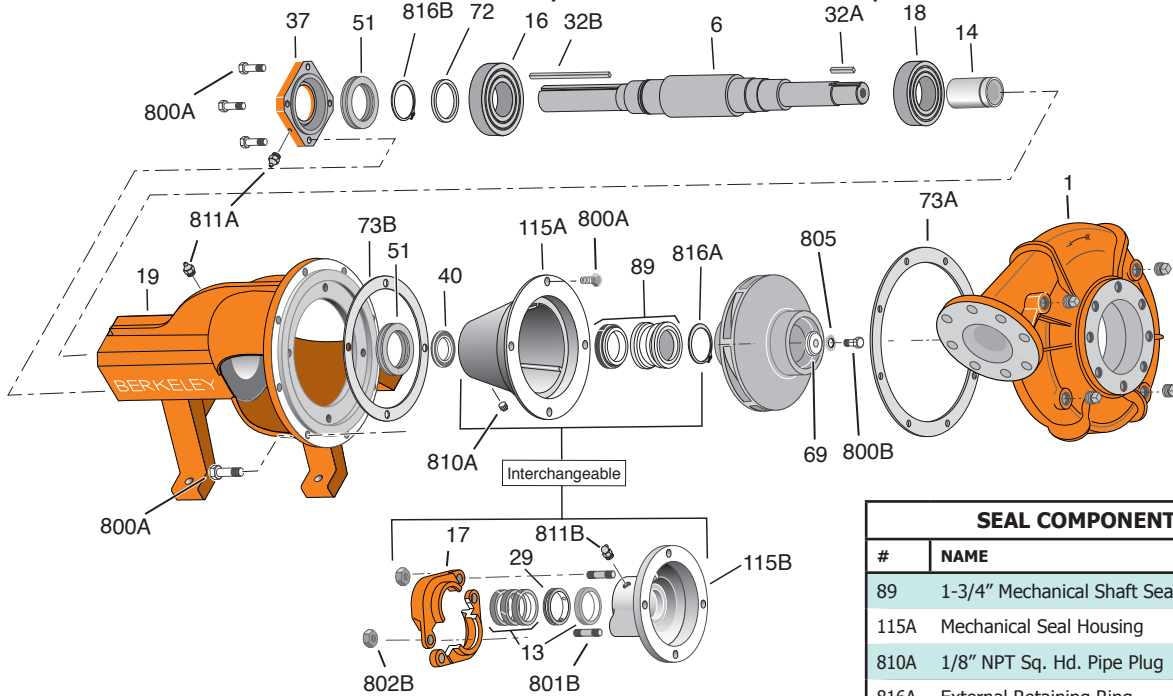

PARTS BREAKDOWN

Berkeley B3ZRM Z Frame Pump



COMMON PARTS		
#	NAME	SKU
6	Shaft	M12338
14	1-3/8 ID x 1-3/4 OD Shaft Sleeve	M12422
16	Single Row Ball Bearing	S13395
18	Ball Bearing	S13397
19	Bracket	M12332
32A	Shaft Key, 1/4" Sq. x 2-1/4" Lg. - Impeller	S23677
32B	Shaft Key 3/8" Sq. x 2-1/4" Lg.	S23941
37	Bearing Cap	M12335
40	Water Slinger	S10964
51	Grease Seal (2 Req.)	M12337
69	Lock Washer	S06319
72	Thrust Ring	S06519
73A	Volute Gasket	S05126
73B	Balance Ring Gasket	S09943
800A	3/8-16 x 1" Lg. Hex Hd. Capscrew (16 Req.)	S26826
800B	1/2-13 x 1" Lg. Hex Hd. Capscrew	S23619
805	Lock Washer	S23038
811A	Grease Fitting (2 Req.)	S23700
816B	External Retaining Ring	S23016

SEAL COMPONENTS		
#	NAME	SKU
89	1-3/4" Mechanical Shaft Seal	S32015
115A	Mechanical Seal Housing	M12333
810A	1/8" NPT Sq. Hd. Pipe Plug	S23714
816A	External Retaining Ring	S16767

PACKING COMPONENTS		
#	NAME	SKU
13	Packing Ring Set	S13435
17	Split Packing Gland Set	B82470
29	Lantern Ring	S19200
115B	Packing Housing	M12334
801B	3/8-16NC x 2-1/2" Lg Stud (2 Req.)	S04438
802B	3/8-16 Hex Nut (2 Req.)	S23343
811B	1/8 MPT x 90 (degree sign) Grease Fitting	S23702

COMPLETE PUMPS					
SERIES	PUMP #	ROTATION	VOLUTE	IMPELLER	SHAFT
	B80302	CW	H00689	M02911	B81663
B3ZRM	B80303	CCW	H00698	M12462	B81663
Packing Construction	B80304	CW	H04040	M02911	B81663
	B80305	CCW	H04041	M12462	B81663
	B80310	CW	H00689	M02911	B81663
B3ZRMS	B80311	CCW	H00698	M12462	B81663
Mechanical Seal	B80312	CW	H04040	M02911	B81663
	B80313	CCW	H04041	M12462	B81663



4806 S 40th St, Phoenix, AZ 85040

© 2018 Access Truck Parts